

Section Through Store 1:10

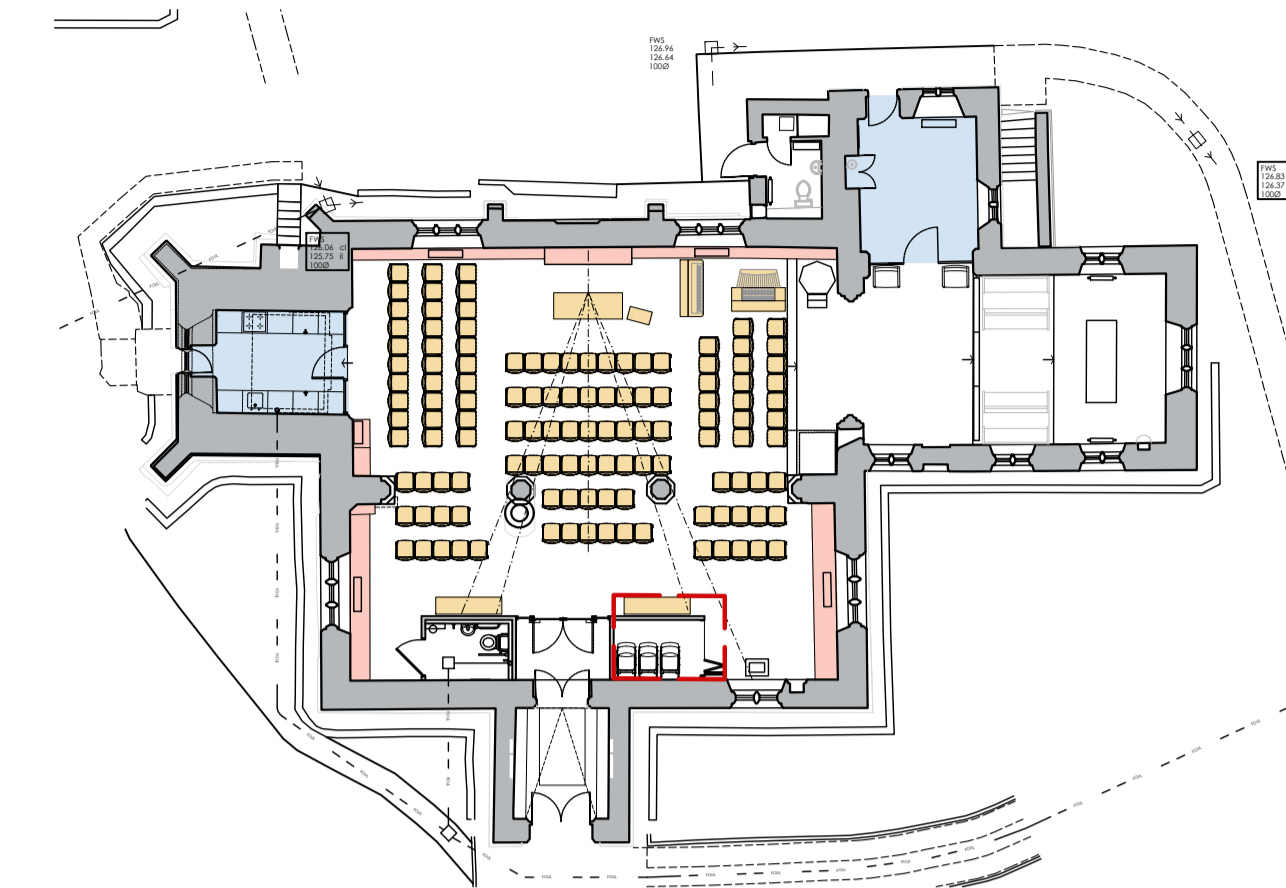

Ground Floor Plan 1:200

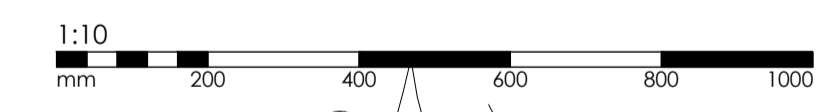

Revision	Date	Initials	Notes
B	30/08/22	MM	General revisions for issue to Faculty
A	26/08/22	MM	Floor Detail Revised

**LYDIARD MILLICENT**  
 All Saints

**Lobby Joinery Details**  
 Section Through Store

Stage  
 FACULTY

**benjamin + beauchamp**  
 architecture design conservation  
 the borough studios, the borough,  
 wedmore, somerset BS28 4EB  
 T 01934 713313 F 01934 713314

Drawn By: MM Date: 30/08/22 Scale: 1:10 of A1  
 Drawing No: 0771.WD.012 Rev B